

Portable Power Station Manual

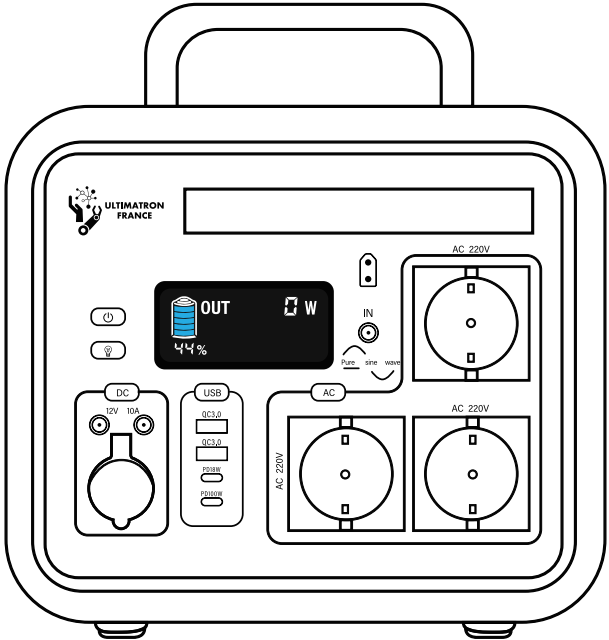

PRODUCT MANUAL

Please read the instructions carefully before using

WARNING



Children aged 3 cannot operate alone

① SHORT BRIEF

This is a portable power station for outdoors and indoors. Apply to wild camping, emergency communication, medical emergency, long drive journey, outdoor fishing. Can supply 1500W power for your devices.

To ensure the most accurate power capacity display: for the initial use, please exhaust all the power in the portable power station, then fully charge it.

② PARAMETER

TYPE	ITEM	PARAMETER
Input	Direct Current Input	DC 5521 12-24-5A
	Direct Current Input	Type-C PD 400W
AC Out 220V	AC Output Voltage	AC Plug AC220V±5%
	AC Output Watt	1500W
	Over-Load Protection	1650W
	AC Output Wave	Pure Sine Wave
	AC Output Peak	3000W Peak Hold Time < 50ms
	Frequency	50Hz
USB Output	USB1 Output	QC3.0MAX 12V/1.5A
	USB2 Output	QC3.0MAX 12V/1.5A
Type-C output	Type-C1	PD18W

TYPE	ITEM	PARAMETER
Type-C Output	Type-C2	PD100W
Wireless Output		15W
DC Output	Cigarette lighter	12V/10A MAX
Charging	Voltage	DC21.9±0.1V
	Time	2.4Hours
	Protection	Short circuit、 over-load、 over-heat、 over-voltage、 over-current、 short-voltage
LED Screen	Show Battery Charging Status	Percentage of battery Charging Status
	Working condition	Showing watt
Battery Pack	Type	LiFePO4
	Pack watt	1000Wh
	Recycle	Over 2000 times
Over-heat Protection	AC over-heat protection	≥85 ℃
	Pack over-heat protection	≥70 ℃
Static boot		<1W

③ PRODUCT USING TIME(DISCHARGE)

DEVICES	DEVICEWATT	DISCHARGINGTIME
Cellphone	4000mAh	Fullcharge 68times
Bulb	40w	Discharge 25hours
Fan	75w	Discharge 13.5hours
Laptop	35w	Discharge 29hours
Cooking machine	500w	Discharge 2hours

As different brand devices, the discharging time is also different. Please subject to reality.

④ PRODUCT SIZE

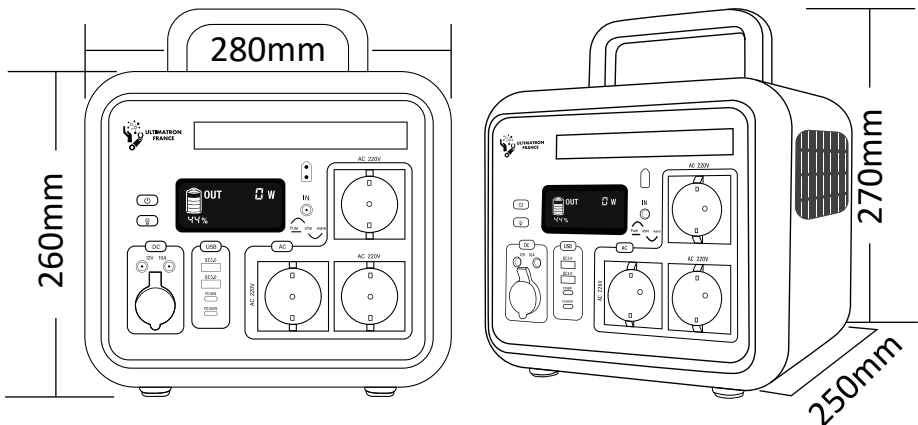

⑤ PRODUCT PANEL DESCRIPTION

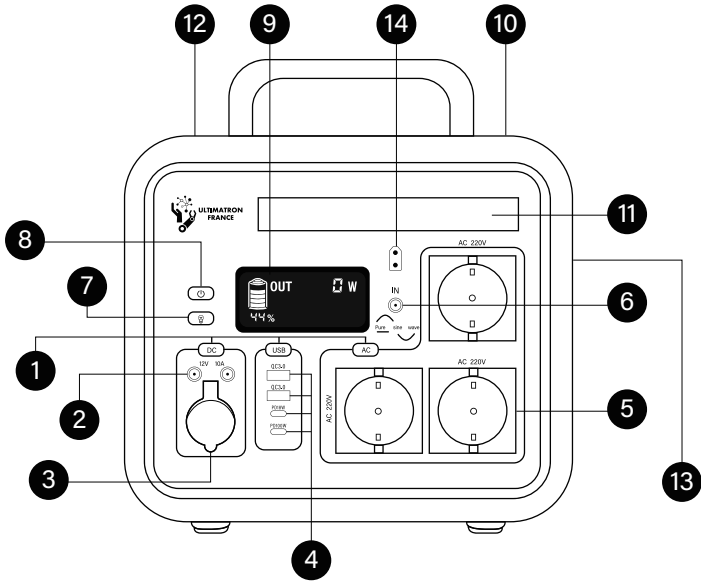

① Solo switch	② DC 12V/10A	③ Cigarette lighter port
④ USB/PD Output	⑤ AC Socket	⑥ IN Charge Port
⑦ LED light Switch	⑧ Turn On/Off	⑨ LCD Screen
⑩ Handler	⑪ LED Light	⑫ Cover
⑬ Vents	⑭ Quick Changing port	

⑥ THE MANUAL OF USB QC3.0 AND PD

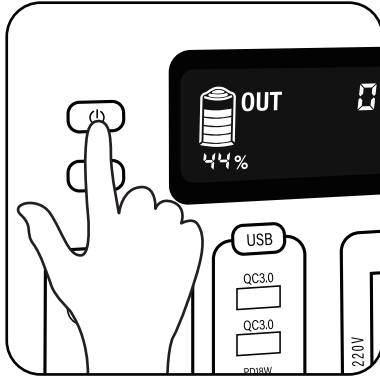

Press the power button for 3 seconds to turn on the device, then the LED screen will turn on.

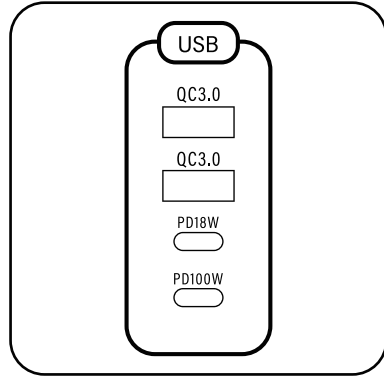

Press the USB button for 3 seconds, then USB icon will show on LED screen and it means that USB is working.

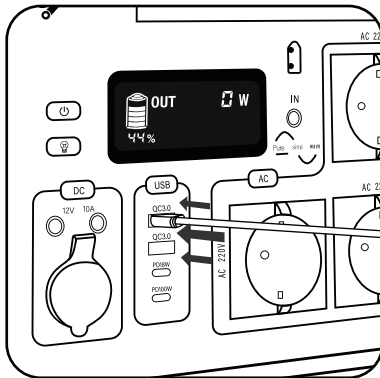

Plug in devices. Start to discharge.

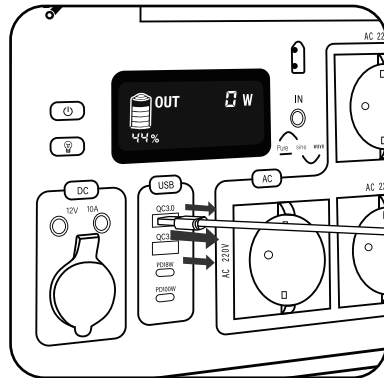

When finish using, Please pull off the plug. The whole device will shut down automatically.

⑦ THE MANUAL OF AC 220V/1500W OUTPUT

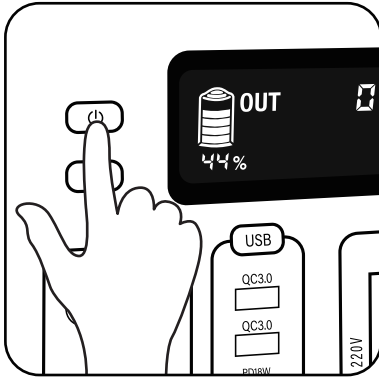

Press the power button for 3 seconds to turn on the device, then the LED screen will turn on.

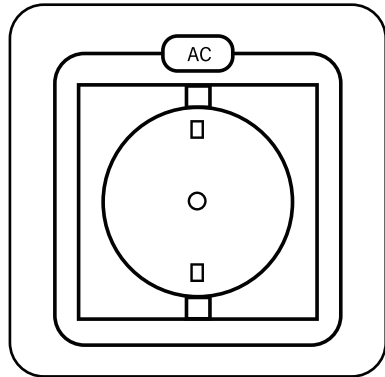

Press the AC button for 3 seconds, then AC icon will show on LED screen and it means that AC is working.

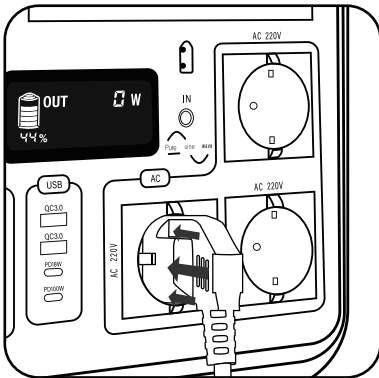

Plug In devices. Start to discharge
Before charging the device, please check whether the power of the device exceeds 1500W, and the energy storage power only supports devices $\leq 1500W$.

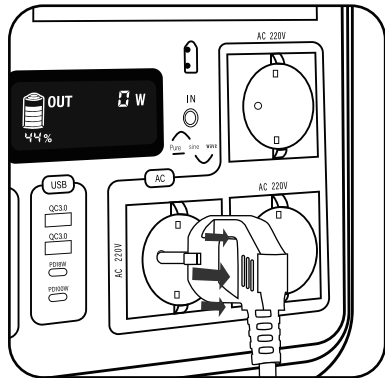

When finish using. Please pull off the plug. The whole device will shut down automatically.

⑧ THE MANUAL OF DC 5521 OUTPUT

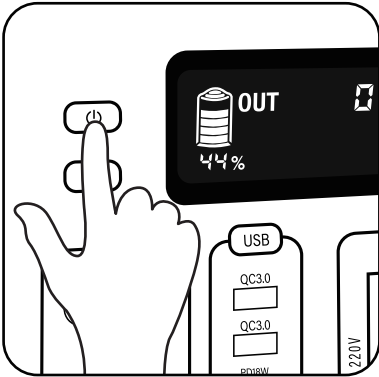

Press the power button for 3 seconds to turn on the device, then the LED screen will turn on.

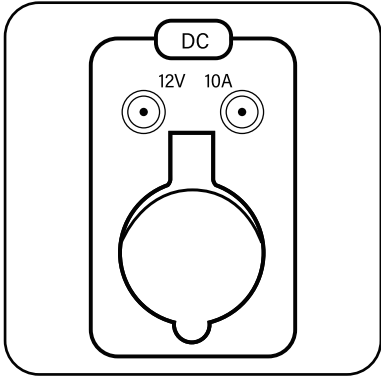

Press the DC button for 3 seconds to turn on the device, then the DC will turn on.

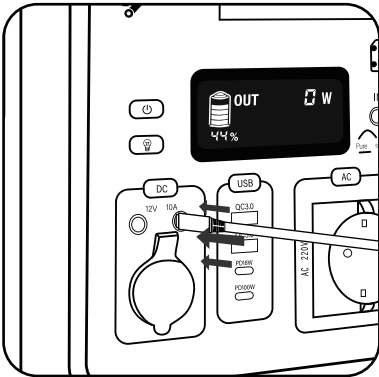

Plug in devices. Start to discharge.

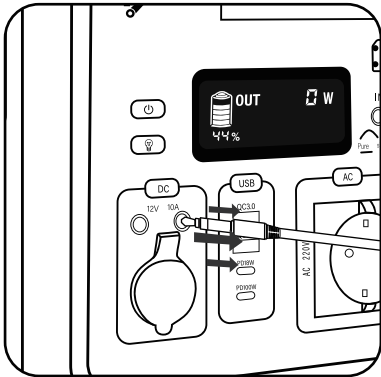

When finish using. Please pull off the plug. The whole device will shut down automatically.

⑨ XT60 Output Manual

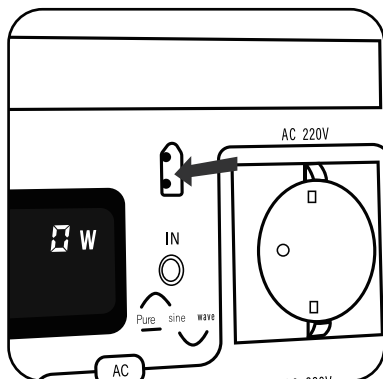

Find the XT60 charging port, in the middle right position of the power bank.

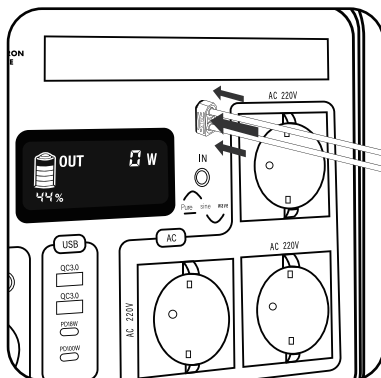

plug in device

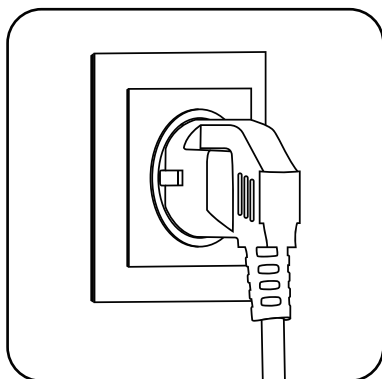

Plug in the power and start charging. 400W fast charging port, it takes 2.5H to fully charge from 10% to 100%.

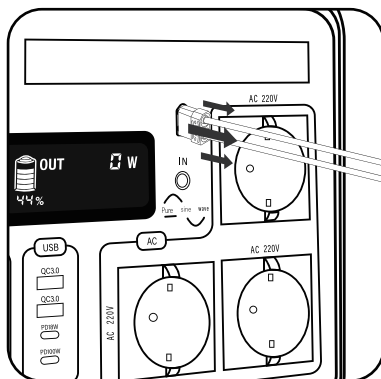

When finish using. Please pull off the plug. The whole device will shut down automatically.

⑩ IN Output Manual

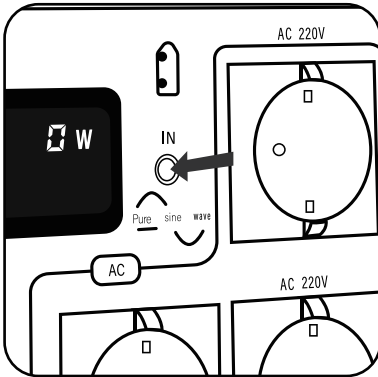

Find the IN charging port, in the middle right position of the power bank.

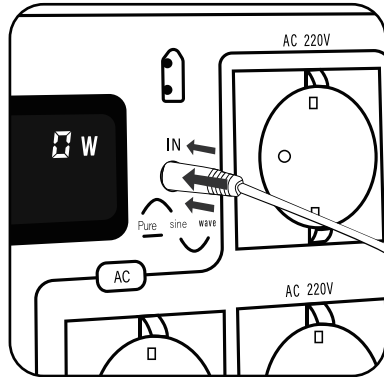

plug in device

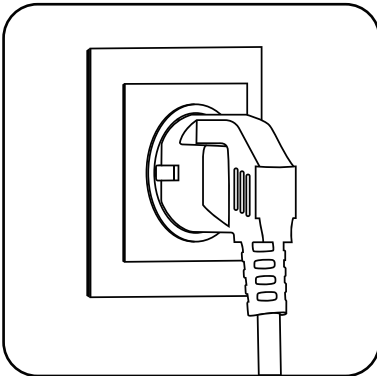

Plug in the power and start charging.

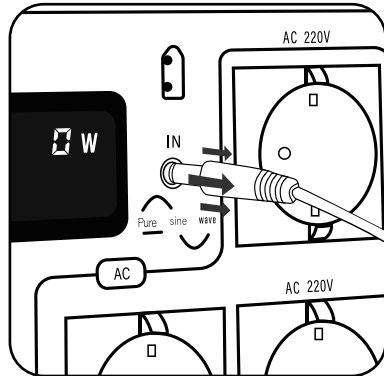

When finish using. Please pull off the plug. The whole device will shut down automatically.

⑪ WARNING

1. Don't put device into water.
2. Don't heat the device or let it expose to any fire sources.
3. Don't tear apart the device..
4. Don't over-hit the product or throw it from a high place.

⑫ ATTENTION

1. Please follow the manuals.
2. Please leave at least 5cm for the air vent. In case of the device overheating.
3. The device will automatically shut off when the electricity of device is not enough or the discharging device watt is bigger than 500W, or in high temperature condition.
4. Please don't charge and discharge at the same time.
5. If you don't use this device for a long time. The electricity may run out. Please charge this device every 6 months.
6. When loading some big watt products. If it's instantaneous power is over 1000W, the device will automatically protect itself. It will turn off the output. Please make sure the loading product need no more than 1000W of instantaneous power.
7. Please don't use this device under some extremely condition, eg:flammable or corrosive condition.
8. If you drop the device into water by accident, please send it back to where you purchased. We will take care of it. If the device damaged by wrong use. We may charge accordingly.